

FLUORESCENT

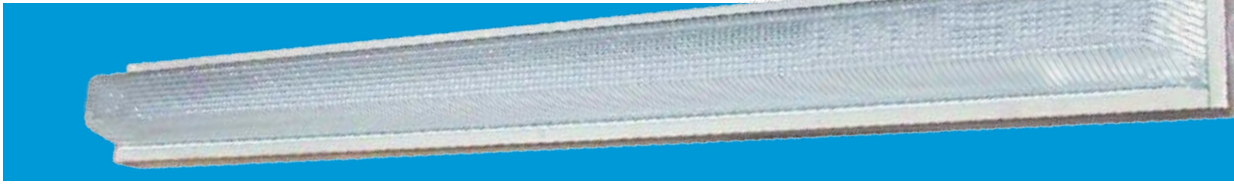

140 Series *Rustproof Vandal Resistant Ceiling Luminaire*



This fluorescent luminaire combines optimal light distribution and energy efficiency with impact resistance in an aesthetically attractive design. Optional emergency battery system eliminates the need for special-purpose lighting. For indoor and covered ceiling outdoor uses, this luminaire is perfect for schools, hospitals, prisons and public, commercial and government buildings.

Specifications

Lens:	Pressure formed of UV-stabilized polycarbonate in average $\frac{1}{8}$ " thickness. Clear lens is enhanced with prisms engineered for maximum light control. End knockouts allow surface conduit or continuous row mounting.
Base Plate:	Die formed of 20-gauge steel with high reflectance white baked enamel finish applied after forming (Post Painted). Provided with end knockouts for $\frac{1}{2}$ " conduit. Optional Marine Grade Aluminum Base Plate available.
Gasket:	Concealed polyethylene gasket is bonded to lens to create a tight seal against contaminants and moisture.
Wireway:	Tool-less tab attachment facilitates installation and removal of wireway channel.
Ballast:	Electronic, thermally protected Class P, energy-saving, High Power Factor ballast for 120V or 120-277V. 40FLT12 Rapid-start 32°F (120V). 32FLT8 Instant-start 0°F (120-277V).
Emergency Battery Pack (optional)	Nickel cadmium battery is maintenance free with a life of 7-10 years and a 90-minute emergency operating time. Battery is charging during normal operations of fixture. During power interruption, lamp will switch to emergency operation. When A.C. power is restored, lamp is switched back to the ballast and the battery is recharged within 24 hours. Note: Can be wired to operate only during power interruption (see options).
Hardware:	Six stainless-steel philips head screws or optional tamperproof screws are provided for lens attachment. Mounting hardware provided by others.

Dimensions

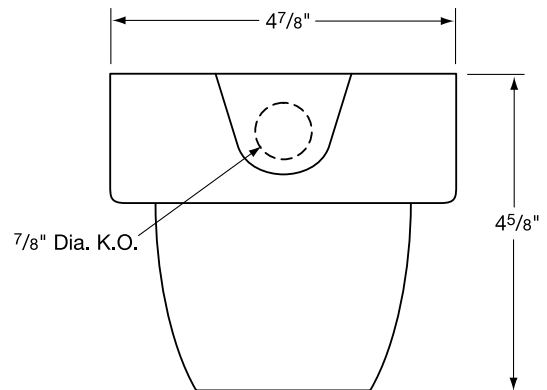

Base Plate Hole Pattern

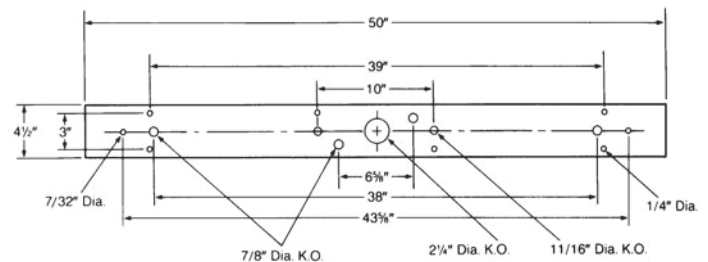

**SBA QUALIFIED
SMALL BUSINESS MANUFACTURER**

TAA COMPLIANT
TRADE AGREEMENT ACT COMPLIANT

ETL-US and ETL-C Listed For Damp Location Covered Ceiling

All polycarbonate components meet Underwriters Laboratories 746C tests for polymeric material and carry a flammability rating of 94HB or better on lenses and the superior 94-5V rating on housings.

Luminaire Type _____
 Catalog Number _____
 Job Name _____
 Approval _____

WF Harris Lighting, Inc.™

Innovative Lighting Designs Since 1970

P.O. Box 5023, Monroe, NC 28111-5023, USA
 704.283.7477 (HEADQUARTERS) • 800.842.9345 (TOLL FREE)
 e-mail: customerservice@wfharris.com
 www.wfharrislighting.com

FLUORESCENT

Ordering Information (Fill In Blanks For Complete Catalog Number)

140 Model	CP Lens	Watts-Lamp	HPF Power Factor	Volts	Options
Model	Lens Color	Watts/Lamp	Power Factor	Volts	Options
140	CP-Clear Prismatic	40FLT12 32FLT8	HPF	120 120-277	

Options
AL -Marine Grade Aluminum Base Plate
EM(1 Lamp) -One Lamp Operates Full Time and During Emergency. Standard Wet Location.
EMO(1 Lamp) -One Lamp Only Operates During Emergency. Standard Wet Location.
FS -Fuse and Holder
TPS -Stainless Steel Torx Type Tamperproof Screws with Speed Nuts
WLO-140 -Wet Location Gasket (Must Specify Application) (Not Required for covered ceiling application)

Accessories (Order Separately)
TPT-Tamperproof Screwdriver



Photometric Data

Model 140-CP-40FLT12
Ceiling Mounted 7.5' M.H.
Test Report No. LRL 189-15A

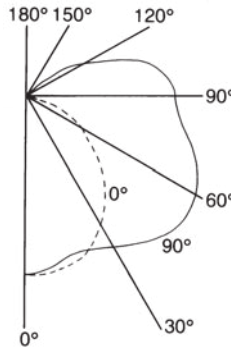
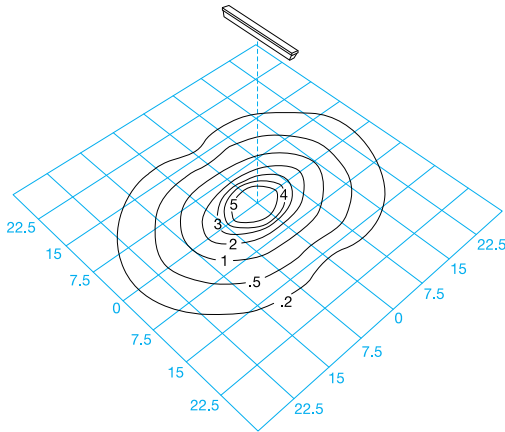

Conversion Tables

Lamp	Lamp Conversion Factor	Mounting Height	Height Conversion Factor
40	1.00	10'	.56
32	.91	12'	.40

Using Conversion Table

TO ADJUST FC, USE FOLLOWING FORMULA WITH LAMP CONVERSION FACTOR (LCF)

AND HEIGHT CONVERSION FACTOR (HCF):

$FC \times LCF = FC$ with alternate lamp

$FC \times HCF = FC$ at alternate height

$FC \times LCF \times HCF = FC$ with alternate lamp at alternate height

COEFFICIENTS OF UTILIZATION — ZONAL CAVITY METHOD EFFECTIVE FLOOR CAVITY REFLECTANCE 0.20

RC	80			70			50			30			10			0		
	70	50	30	10	70	50	30	10	50	30	10	50	30	10	50	30	10	0
1	77	72	67	63	73	69	64	61	62	59	56	56	54	51	51	49	47	44
2	69	61	55	49	65	58	53	48	53	48	44	48	44	40	43	40	37	34
3	62	53	46	40	59	51	44	39	46	40	36	41	37	33	37	34	31	28
4	57	46	39	33	53	44	37	32	40	34	30	36	31	27	33	29	25	23
5	52	41	33	28	49	39	32	27	35	29	25	32	27	23	29	25	21	19
6	48	36	29	24	45	35	28	23	32	26	21	29	24	20	26	22	19	16
7	44	33	25	20	41	31	25	20	28	23	18	26	21	17	24	19	16	14
8	40	29	22	18	38	28	22	17	26	20	16	23	19	15	21	17	14	12
9	38	27	20	16	36	26	19	15	23	18	14	21	17	13	20	15	12	11
10	35	24	17	13	33	23	17	13	21	16	12	19	14	11	17	13	10	9



SBA QUALIFIED
SMALL BUSINESS MANUFACTURER

TAA COMPLIANT
TRADE AGREEMENT ACT COMPLIANT

W.F. Harris Lighting, Inc.™

Innovative Lighting Designs Since 1970

P.O. Box 5023, Monroe, NC 28111-5023, USA

704.283.7477 (HEADQUARTERS) • 800.842.9345 (TOLL FREE)

e-mail: customerservice@wfharris.com

www.wfharrislighting.com

Specifications Subject to Change Without Notice

Fixture is Warranted to be Free of Defects in Materials and Workmanship for One Year From Invoice Date.

Printed in USA

Form 1539

10/16

"W. F. Harris Lighting Will Not Sacrifice Quality for the Sake of Price"